

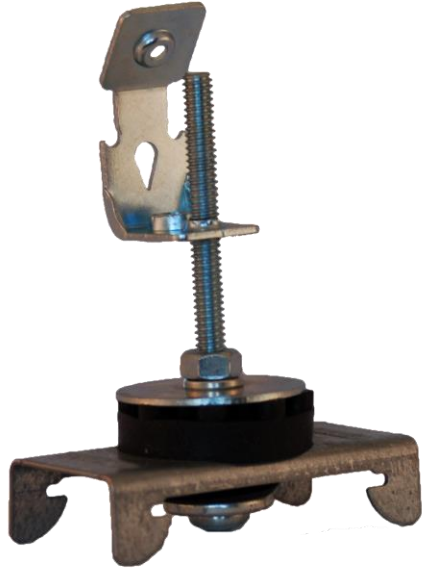

RSIC-1 ADM Multi Clip

(RSIC-1 ADM SHOOT IN)



The **RSIC-1-ADM Multi Clip** designed for use with Concrete, Steel or Wood framed ceilings where noise control is required. The RSIC-1-ADM Multi Clip isolator is a labor saving adjustable mount ceilings. Fasten the clip to the framing or concrete and and spin the isolator to adjust up and down for a level ceiling. With an Acoustical design load rating of 36 lbs per isolator, the RSIC-1-ADM Multi Clip clip can support up to two layers of 5/8" gypsum board when spaced at 24" x 48" oc., and 3 layers when spaced at 16" x 48" oc. The RSIC-1-ADM Multi Clip clip attaches directly to the bottom of the framing or concrete, or to the side of a wood, or steel joist decoupling the gypsum board from the structure stopping STC and IIC vibrations from entering the space below.

RSIC-1 ADM Multi Clip, the Low Cost, High Performance, Noise control Solution

Steel
Condo
Commercial

Apartment
Retail
Conference Rooms

Recording Studio
Home Theater
Commercial theater

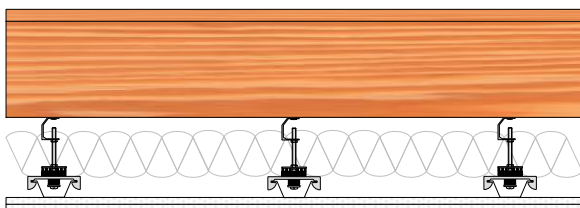
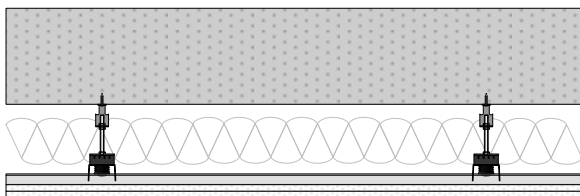
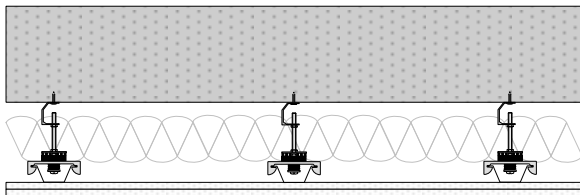

RSIC-1-ADM Multi Clip specifications:

Acoustical design load:	36 Lbs
Total deflection	3 mm
Double deflection	Yes (1.5 mm)
Made with Recycled content	Yes
Cryo low VOC treated	Yes
Adjustable	Yes
Cavity min	2-5/8"
Cavity Max	Up to 12"
Adjustment limit	Threaded Rod
Use on Ceilings	Yes
Use on walls	No
New Construction	Yes
Retro Fit	Yes